

The Courses and Distances Beginning at a on the South Side of Swadara Creek Down in Alphabetical order of Letters.

- a-n-84-N-10
- b-n-61-N-10
- c-n-30-N-10
- d-n-40-E-8
- e-n-53-E-15
- f-n-24-E-7
- g-n-20-E-8
- h-north-8
- i-n-8-W-7
- j-n-25-W-10
- k-n-28-W-9
- l-n-75-W-8
- m-5-82-W-7
- n-5-62-W-8
- o-5-80-W-15
- p-n-72-W-6
- q-n-75-W-9
- r-n-70-W-9
- s-n-60-W-9
- t-5-85-W-8
- u-n-87-W-6
- v-n-77-W-6
- w-n-88-W-6
- x-n-85-W-6
- y-5-86-W-10
- z-5-76-W-9
- 8-5-85-W-9

233 perches
Down to the place of Crossing the Creek north 60 w 3 perches

at the Courses and Distances Beginning the Crossing of the Swadara by Benj Webb 3 perches north from the Corner B, thence up the Creek Along vacant Land in Alphabetical order from

- a n 54 E 12
- B n 89 E 10
- C S 80 E 9
- D S 78 E 6
- E S 70 E 5
- f north 1
- g S 80 E 6
- h East 9
- i S 62 1/2 E 10
- J S 65 E 10
- K S 70 E 8
- L S 71 E 8
- m S 78 E 13
- n n 60 E 7
- O n 85 E 8
- p S 59 E 12
- q S 10 E 10
- R S 23 E 10
- S S 12 1/2 E 9
- t S 5 W 9
- u S 20 W 9
- v S 21 W 6
- w S 50 W 16
- x S 45 W 6
- y S 52 E 7
- z S 73 E 9
- 8 S 85 E 9

234 perches

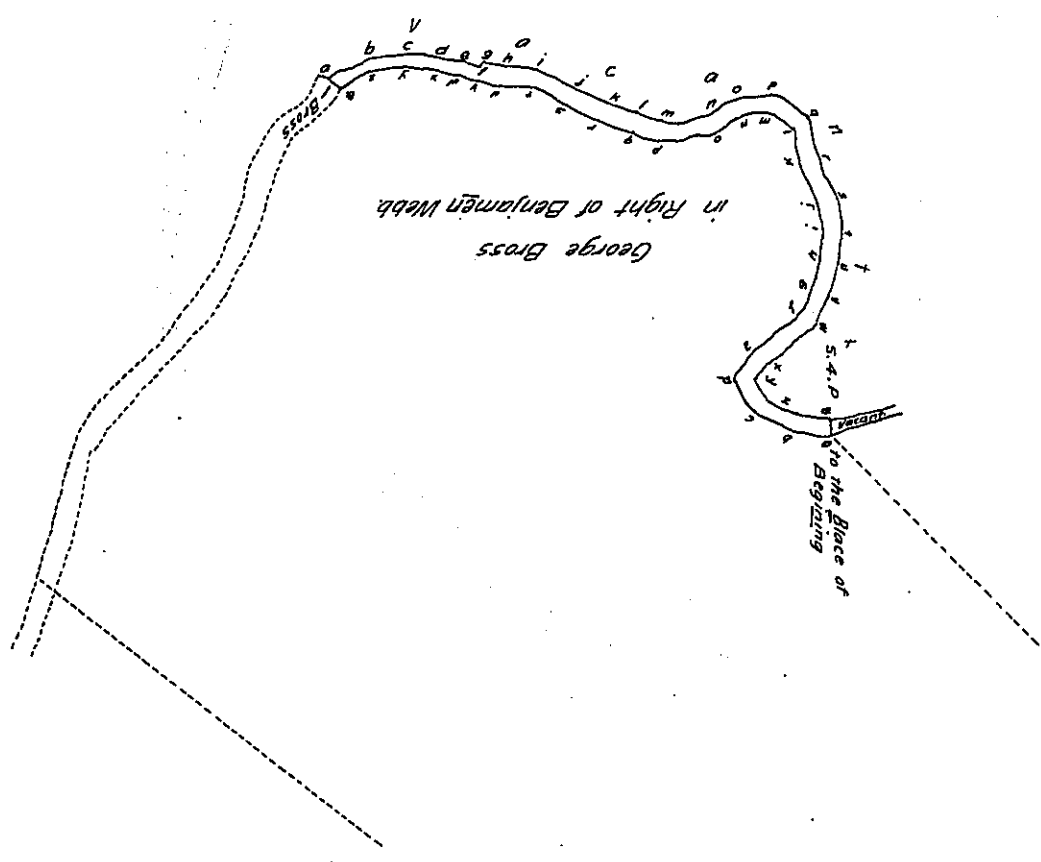

Draught of a Tract of Land Situate in Bethel Township Lebanon County Surveyed on a Warrant Granted to George Cross the 26th day of December 1873 Containing five acres & 49 perches. Surveyed for George Cross June 19th 1874 and Returned into the Surveyers General office.

Martin Meily C. S.

To Robert B. Beath
Surveyor General of Pa.

Whereas July 22nd 1874 an explanation about the Swadara Creek as fair as George Cross applied for 5 acres 49 perches is only part of the vacant Land then the Swadara - never was any application taken out and the Distance Crossing the Creek is 8 perches George Cross application is on the South Side along as fair as his Land goes the Tract is the Cours Given in Benjamin Webb Cours or tract 1737 Since that time the Swadara - Shifted Different Courses all on the north Side a good deal more then the Width of the Creek on some places Depriving him having Excess to the Said Creek.

the Survey was made for Benj Webb Down the Swadara Creek 232 perches on the South Side then Crossing ^{north side} the Rudolph Huntsacres Survey was made 1742 on the north Side of Said Creek and Down Said Creek and principally on huntsacres Land and on some places the Line is on the South Side of the Creek where it is the Swadara - Runs now

IN TESTIMONY that the above is a copy of the original remaining on file in the Department of Internal Affairs of Pennsylvania, made conformably to an Act of Assembly approved the 16th day of February, 1833, I have hereunto set my Hand and caused the Seal of said Department to be affixed at Harrisburg, this

twenty sixth day of October 1904

Isaac B. Brown
Secretary of Internal Affairs.